

## Miller Road Colliers Wood, SW19 2DB

£459,950 Leasehold

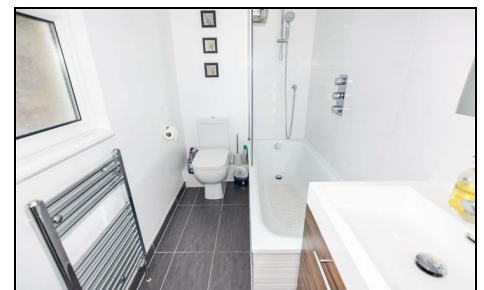

Beautifully presented TWO bedroom PERIOD conversion flat with PRIVATE GARDEN. Spacious kitchen/breakfast room and long lease over 170 years. Sought after central location near to Colliers Wood Tube station and high street. A fantastic home for any first time buyers looking to get onto the SW19 property market.

## Miller Road, SW19

Approximate Gross Internal Area  
54.5 sq m / 587 sq ft

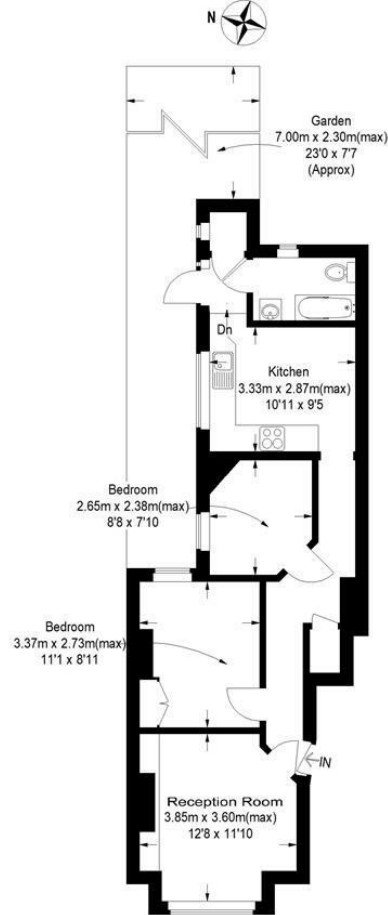

This floor plan is for representation purposes only and is not drawn to scale.  
The Gross Internal Area includes outbuildings shown on the plan.  
Whilst every attempt has been made to ensure the accuracy of the plan measurements of doors, windows and rooms are approximate only and should be checked before making any decisions reliant upon them.  
Copyright Bespokeplans.co.uk (ID584007)

- Two Bedrooms
- Period Property
- Long Lease
- Central Colliers Wood Location
- Private Garden
- EPC Rating : C

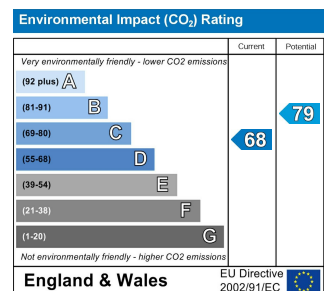
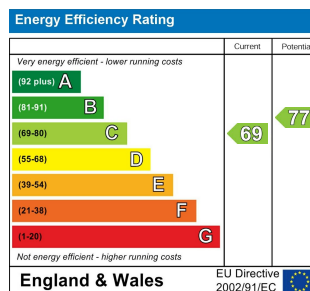

For Free Mortgage Quote and Best Mortgage Rates, call an Ellisons Mortgage Advisor on 020 8544 0518



Although these particulars are believed to be correct, their accuracy is not guaranteed and they do not form part of any contract.

Celebrating 30 years of successful Sales and Lettings in Merton

